

# TIMBER POLE RAFT FOUNDATION TYPICAL CONSTRUCTION SEQUENCE

Type RFT1

Raft Foundation – suspended timber floor with lightweight claddings\*

1

Raft Foundation pit excavated.

---

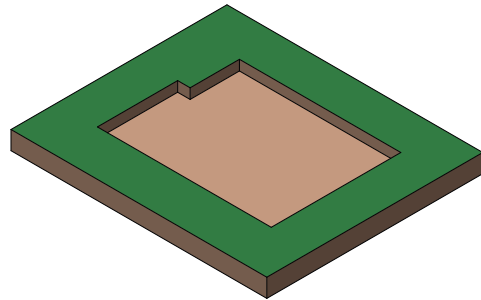

2

MultiPole UniLog primary foundation beams laid over Geo Cloth.

---

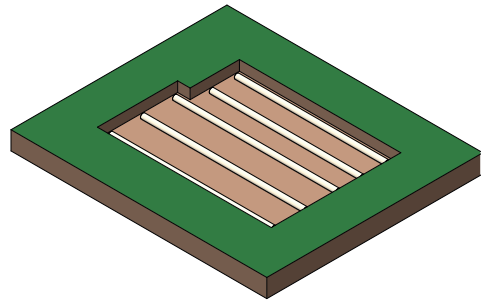

3

MultiPole UniLog secondary foundation beams placed over primary foundation beams in a specifically designed perpendicular lattice. Beams are prepared for proprietary connections.

---

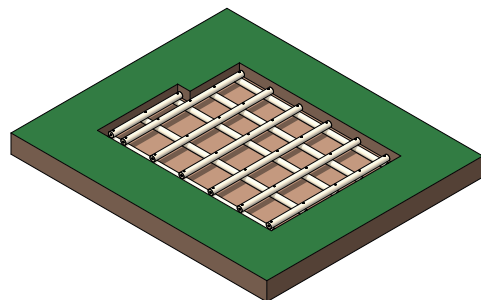

\* Lightweight claddings as determined by the relevant NZ building codes



# TIMBER POLE RAFT FOUNDATION TYPICAL CONSTRUCTION SEQUENCE

4

UniLog jack studs are connected to foundation beams, levelled and scarfed. Underground services can be placed under, over and between foundation beams as required.

---

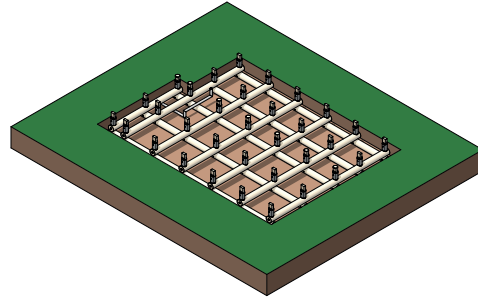

5

Excavated pit fill material placed and compacted.

---

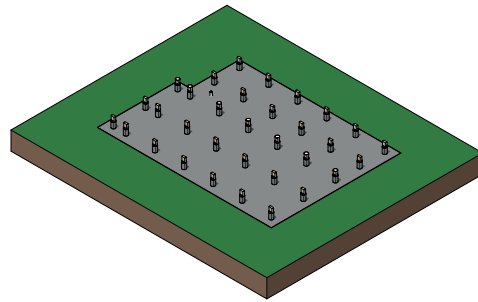

6

Primary timber bearers are seated onto scarfed jack studs.

---

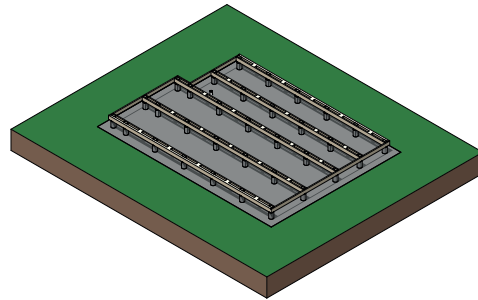

7

Suspended timber floor installed.

---

