

TIMBER POLE RAFT FOUNDATION TYPICAL CONSTRUCTION SEQUENCE

Type RFTX1

Raft Foundation – cross laminated timber floor with lightweight claddings*

1

Raft Foundation pit excavated.

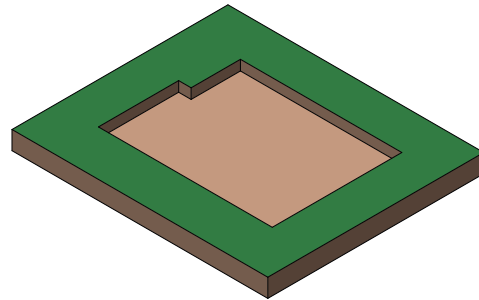

2

MultiPole UniLog primary foundation beams laid over Geo Cloth.

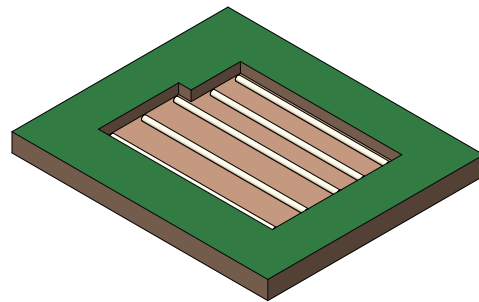

3

MultiPole UniLog secondary foundation beams placed over primary foundation beams in a specifically designed perpendicular lattice. Beams are prepared for proprietary connections.

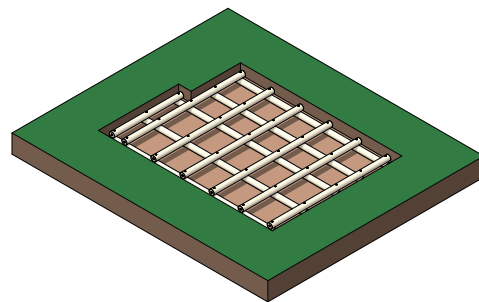

* Lightweight claddings as determined by the relevant NZ building codes



TIMBER POLE RAFT FOUNDATION TYPICAL CONSTRUCTION SEQUENCE

4

UniLog jack studs are connected to foundation beams, levelled and scarfed. Underground services can be placed under, over and between foundation beams as required.

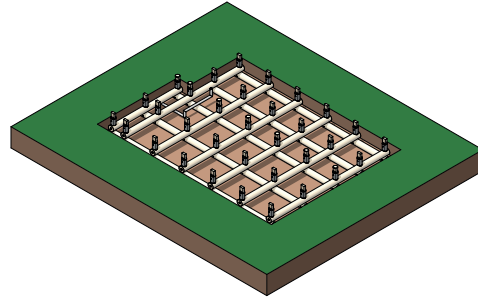

5

Excavated pit fill material placed and compacted.

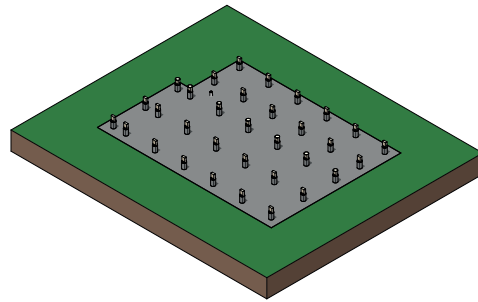

6

Primary timber bearers are seated onto scarfed jack studs.

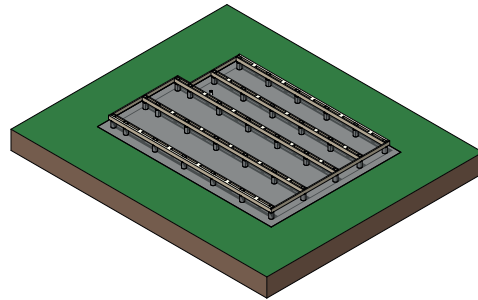

7

Cross laminated timber (CLT) floor panel installed.

